



COTTONWOOD SPRINGS WATER STEWARDS

Winter Watering Schedule: Have you changed your clocks yet?

From Nov. through Feb. the Winter Watering Schedule is in effect. SNWA guidelines stipulate that outdoor watering should happen a maximum of (1) day per week, and never on Sundays. Your assigned watering day is on the map below.

Remember, we are aiming for 100% resident participation! Let us know if you are having any issues complying, or need help in resetting your irrigation clocks. Thanks for helping us conserve!

Want to know your usage?

Email us at water@saveredrock.com , or call us at 702-232-3965 to see the statistics of your water use.

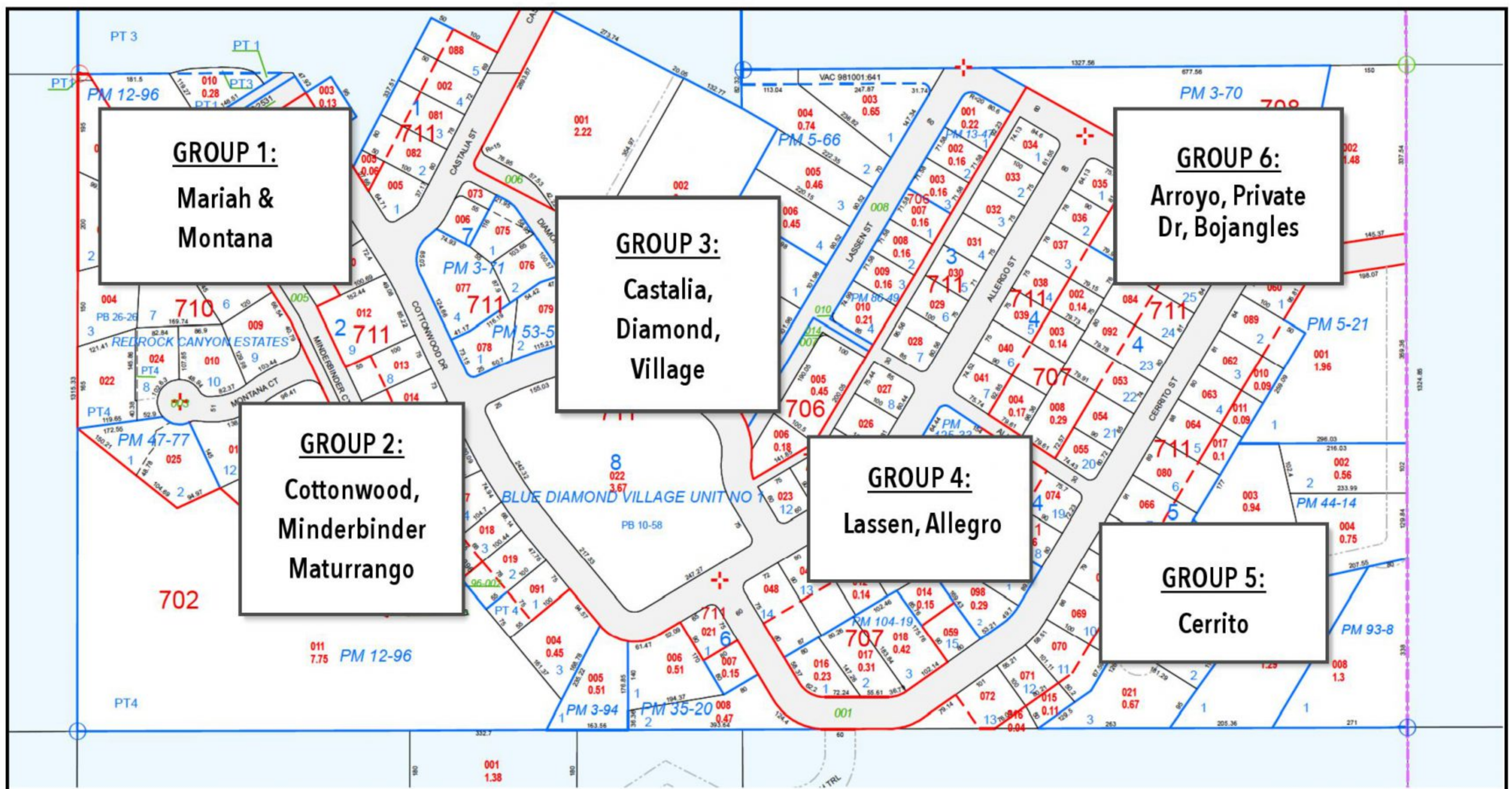

WATERING GROUPS

Group 1:	Mondays	Group 4:	Thursdays
Group 2:	Tuesdays	Group 5:	Fridays
Group 3:	Wednesdays	Group 6:	Saturdays



COTTONWOOD SPRINGS WATER STEWARDS



GOT A QUESTION?

Send your botany inquiries to Fred at
water@saveredrock.com

And, don't forget!

Remember to wrap and insulate
exposed water lines and pipes to
prevent winter freezing and future
leaks!

ASK THE BOTANIST

The Water Stewards include experts in botany, land management, environmental science and more. We've asked these experts to provide you with regular tips and information on how to save water.

Q: If I don't have grass, how often should I be watering my trees and shrubs in winter?

A: Assuming you are satisfied with your irrigation the rest of the year, in winter we can sufficiently water our trees twice per month for deciduous trees (those that drop leaves in winter, like cottonwoods) and once per week or 10 days for evergreen trees (those that maintain leaves in winter, like pines). The amount of water a plant receives doesn't change seasonally, only the frequency of water changes.

Generally rooting depths for small shrubs are 12" deep, for large shrubs 18" deep, for large trees 24" deep. You can test the depth of watering by inserting a 4' long, 3/8" wide piece of rebar into the wetted area until you meet resistance, an hour after a watering.

There are two basic ways to overwater trees in winter: watering too frequently (time) and watering too much (volume) at a given time. The most damaging is by watering too frequently.

News Update!

The LVVWD moratorium on new water commitments in Blue Diamond Village has passed and is now in effect. If you'd like to learn more about the conservation plan for our area, visit lvvwd.com

Sign up for our e-newsletters and see what else we are working on!

water@saveredrock.com

www.saveredrock.com/water

702-232-3965